

RS-132HC Series

Framed 132 Layout Mono Module
PERC Half-Cell: 650~700W

PRODUCT: RS-132HC(cells)
PRODUCT RANGE: 650~700w

DIMENSIONS OF PV MODULE(mm)

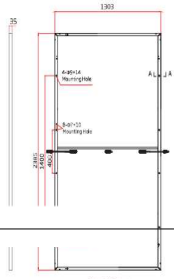

RSM50M-132HC / I-V CURVES

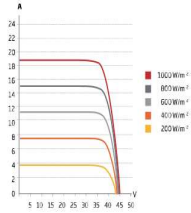

Frame Cross Section A-A

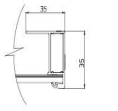

Mounting Hole

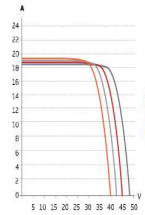
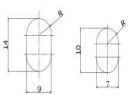

ELECTRICAL DATA (STC)

Peak Power Watts-Pmax (W) ¹	650	660	670	680	690	700
Power Tolerance-Pmax (W)	0 ~ +10					
Maximum Power Voltage-Vmp (V)	37.9	38.3	38.7	39.1	39.5	39.9
Maximum Power Current-Imp (A)	17.16	17.24	17.32	17.40	17.48	17.55
Open Circuit Voltage-Voc (V)	45.0	45.4	45.8	46.2	46.6	47.2
Short Circuit Current-Isc (A)	18.39	18.47	18.55	18.63	18.71	18.79
Module Efficiency (%)	20.9	21.2	21.6	21.9	22.2	22.5

STC: Irradiance 1000W/m², Cell Temperature 25°C, Air Mass 1.5, "Standard Reference Cell"

MECHANICAL DATA

Solar Cells	Monocrystalline
No. of cells	132 cells
Module Dimensions	2305x1303x35 mm
Weight	34.4 kg (75.8 lb)
Front Cover	3.2mm Tempered Glass
Encapsulant material	EVA/POE
Backsheet	White
Frame	Anodized Aluminum Alloy, Oxidizer Enhanced
J-Box	IP68, 3 Bypass Diodes
Cables	Photovoltaic Technology Cable 4.0mm ² (0.1006 inches) ² , 460/340mm (18.1/13.4 in) (supply additional jumper cables 2 lines / Pallet) (customized length)*
Connector	T4 Series or MC4-EVQ2

*Please refer to supplier for detailed specification.

ELECTRICAL DATA (NOCT)

Maximum Power-Pmax (W)	487	495	502	510	518	525
Maximum Power Voltage-Vmp (V)	35.5	35.9	36.3	36.7	37.1	37.5
Maximum Power Current-Imp (A)	13.74	13.79	13.85	13.91	13.97	14.03
Open Circuit Voltage-Voc (V)	42.5	42.9	43.3	43.7	44.1	44.5
Short Circuit Current-Isc (A)	14.83	14.89	14.96	15.03	15.11	15.18

NOCT: Irradiance 800W/m², Ambient Temperature 20°C, Cell Temp. 45°C

TEMPERATURE RATINGS

NOCT Nominal Operating Cell Temperature	41 ~ 49°C	Operational Temperature	-40°C ~ +85°C
Temperature Coefficient of Pmax	-0.34%/°C	Maximum System Voltage	1500V DC (IEC)
Temperature Coefficient of Voc	-0.26%/°C	Max Series Fuse Rating	30A
Temperature Coefficient of Isc	0.05%/°C		

WARRANTY

12 year Product Workmanship Warranty
25 year Power Warranty
2% first year degradation
0.55% Annual Power Attenuation
(Please refer to supplier warranty for details)

PACKAGING CONFIGURATION

Modules per box: 32 pieces
Modules per 40' container: 1536 pieces



MORE POWER

- 700W** Module power up to 700 W
700 W Module efficiency up to 22.5%
- \$** Up to 3.5 % lower LCOE
Up to 5.7 % lower system cost
- Bar chart** technology, up to 50% lower degradation
- Cloud** Better shading tolerance

MORE RELIABLE

- Thermometer** 40 °C lower hot spot temperature, greatly reduce module failure rate
- Shield** Minimizes micro-crack impacts
- ***** Heavy snow load up to 5400 Pa, wind load up to 2400 Pa*
- 12 Years** Enhanced Product Warranty on Materials and Workmanship*

1st year power degradation no more than 2%
Subsequent annual power degradation no more than 0.55%

*According to the applicable Rosen Solar Warranty Statement.